

1	Type	ToF Lens				
2	Resolution	MP				
3	Image Format	1/2"				
4	Image Circle	φ8.3mm(MAX)				
5	EFL	7.76mm				
6	TTL	23.64mm				
7	F/NO.	F1.2				
8	FFL (M)	1.79mm				
9	BFL (O)	4.37mm				
10	For Sensor	MLX75027	OPT8241	MN34906	OPT8320	
11	FOV	H	48°	35.9°	26.7°	17.9°
12		V	35.9°	26.9°	20°	13.4°
13		D	60°	44.9°	33.5°	22.4°
14	OPT Distortion	<-10.0%				
15	Relative Ill.	>55%				
16	Chief Ray Angle	<29.22°				
17	M.O.D	0.1m~∞				
18	Mount Type	M12*P0.5				
19	Dimension Figure	φ18.0*L23.64mm				
20	Lens Structure	7G				
21	IR-Filter	Non IR				
22	Weight	8.5g				
23	Iris Operation	Fixed				
24	Zoom Operation	Fixed				
25	Focus Operation	Manual				
26	Operating Temperature	-20° ~+85°				
27	Storage Temperature	-20° ~+85°				

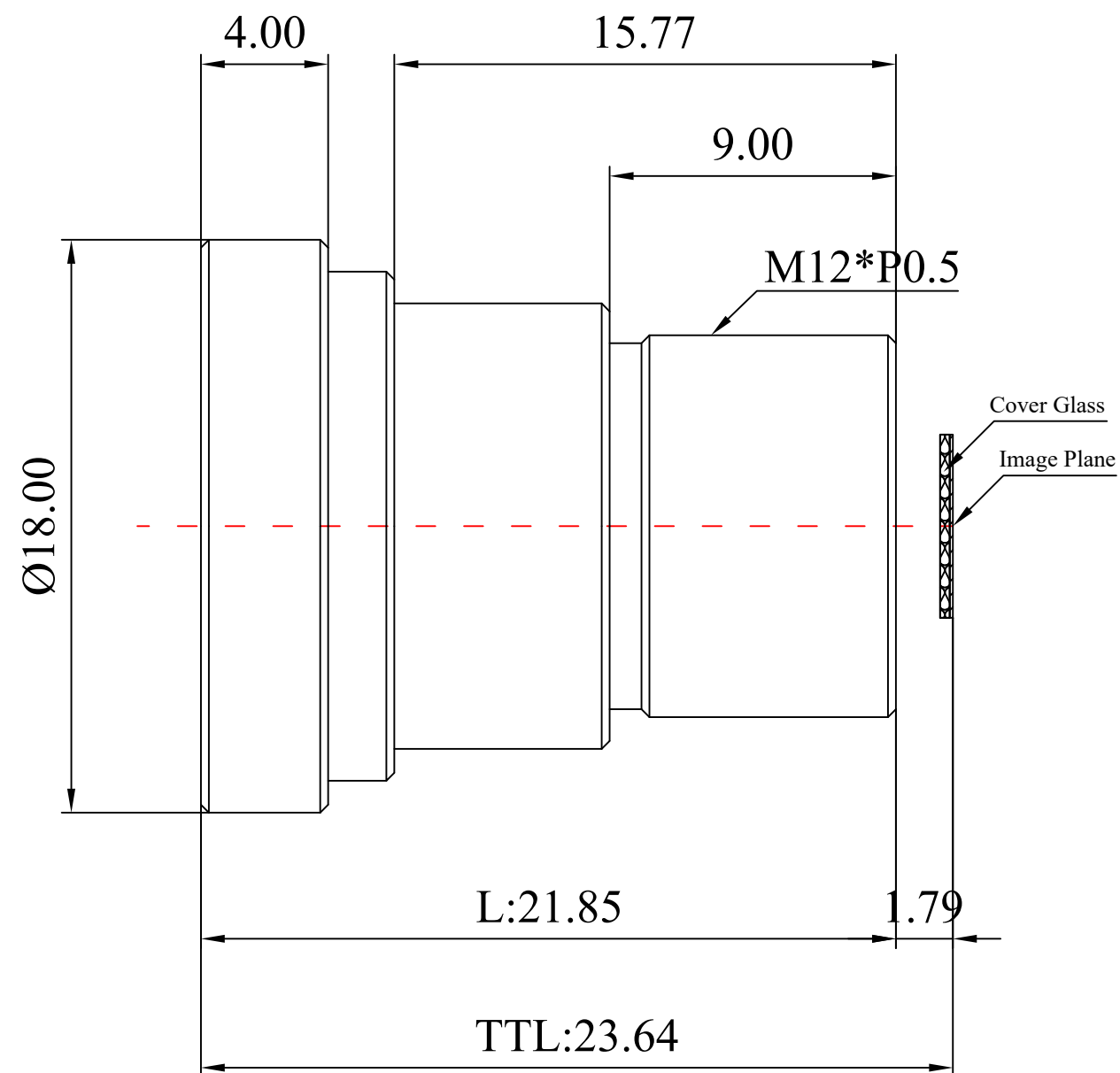
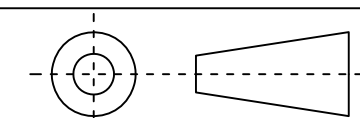

Scale	Remark	Tolerances	Date	Revised		福州创安光电科技有限公司 FUZHOU CHUANGAN OPTICS CO., LTD
4: 1	X	± 0.2	2020-12-07	CH3738A Rev1.0		
	X.0	± 0.15				
Units	X.00	± 0.10	Design	Linda	2018-03-11	
	X.000	± 0.001	Checked	Anna	2018-04-12	
mm	Angle	± 0.5°	Approval	Sanmu	2018-08-10	

**3D Angle Projection**